

FOR LEASE

Office / Warehouse Spaces



2727 S. Jefferson, St. Louis, MO 63118

- * Great location on S. Jefferson
- * Close to highways and downtown
- * Two nicely finished office spaces
- * Two large warehouse spaces

For Lease:

~~2727 S. Jefferson - Office - approx. 2,200 sq. ft. - \$2,200/month plus utilities -~~ **Temporarily off market**
~~2727 S. Jefferson - Warehouse - approx. 4,500 sq. ft. - \$1,000/month plus utilities -~~ **Temporarily off market**
~~2731 S. Jefferson - Office - approx. 1,200 sq. ft. -~~ **LEASED**
~~2731 Rear S. Jefferson - Warehouse - approx 3,800 - 4,000 sq. ft. -~~ **LEASED**

2725 S. Jefferson - 2nd Floor Office - approx. 8,000 sq. ft. - \$2,000 per month plus utilities - 'as is'



**DUFFE
NUERNBERGER
REALTY**

1425 South 18th Street
St. Louis, Missouri 63104
(314) 771-5335

CONTACT:

Cindy Washington
(314) 494-6566

cwashington@ndconsulting.com

Susan Sauer
(314) 571-7654

ssauer@ndconsulting.com

Flyer on the web at: www.dnrealty.com

2727 and 2731 S. Jefferson - Site Plan

2727 S. Jefferson - Office
approx. 2,200 sq. ft.

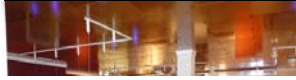

TEMPORARILY OFF MARKET



2727 S. Jefferson - Warehouse
approx. 4,500 sq. ft.



TEMPORARILY OFF MARKET

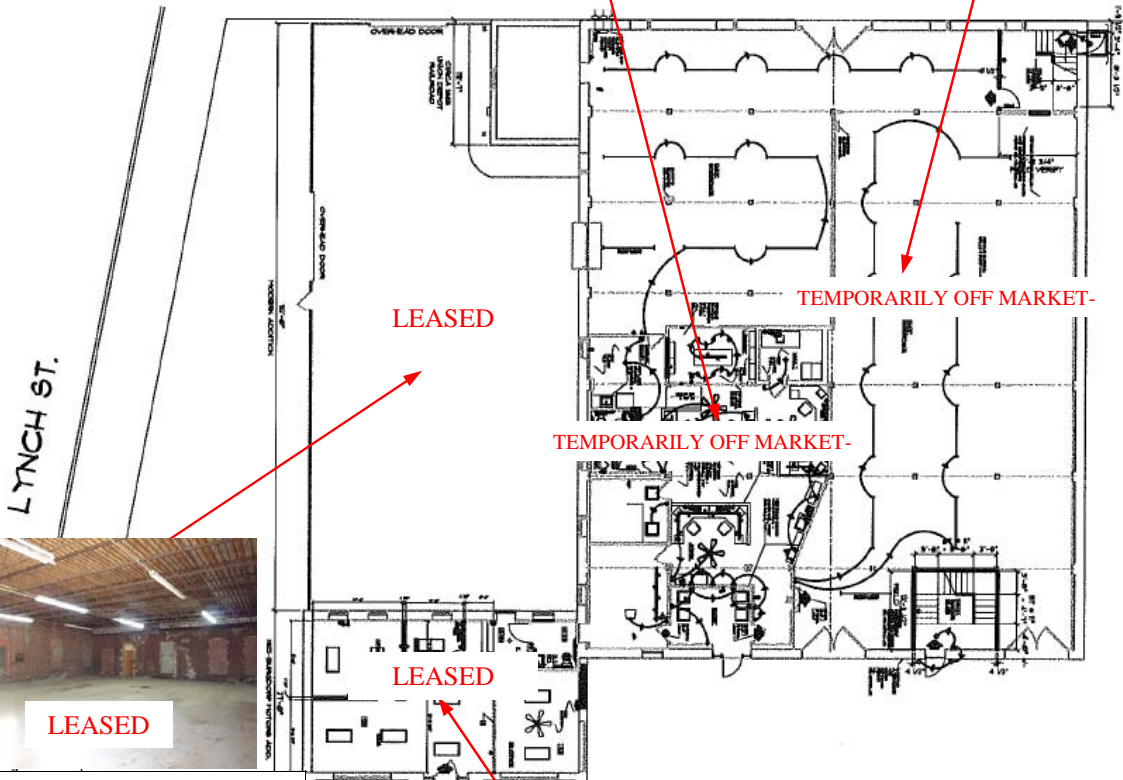
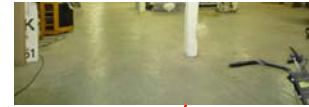

LEASED

2731 Rear S. Jefferson - Warehouse
approx. 3,800-4,000 sq. ft.



LEASED

2731 S. Jefferson - Office
approx. 1,200 sq. ft.



**DUFFE
NUERNBERGER
REALTY**

1425 South 18th Street
St. Louis, Missouri 63104
(314) 771-5335

CONTACT:

Cindy Washington
(314) 494-6566

cwashington@ndconsulting.com

Susan Sauer
(314) 571-7654

ssauer@ndconsulting.com

Flyer on the web at: www.dnrealty.com