

FOR LEASE

50,000+ Sq. Ft. Stand Alone Building



**490 N. Kingshighway Blvd.
St. Louis, MO 63108**

- * Over 50,000 sq. ft. on two floors
- * Desirable CWE location
- * Abundant natural light
- * Freight elevator and ramp to roof
- * Endless possible reuses....antique mall, school, retail operation, gallery, gym, etc.
- * Built in 1925 as first Buick dealership west of the Mississippi
- * Located within Historic District

PLEASE DO NOT DISTURB TENANTS!

For Lease: \$4.00 per sq. ft.



**DUFFE
NUERNBERGER
REALTY**

1425 South 18th Street
St. Louis, Missouri 63104
314-771-5335
314-771-7268 fax

CONTACT:

Susan Sauer
314-571-7654
ssauer@ndconsulting.com

Michele Duffe
314-571-7646

Flyer on the web at: www.dnrealty.com

490 N. Kingshighway Blvd.

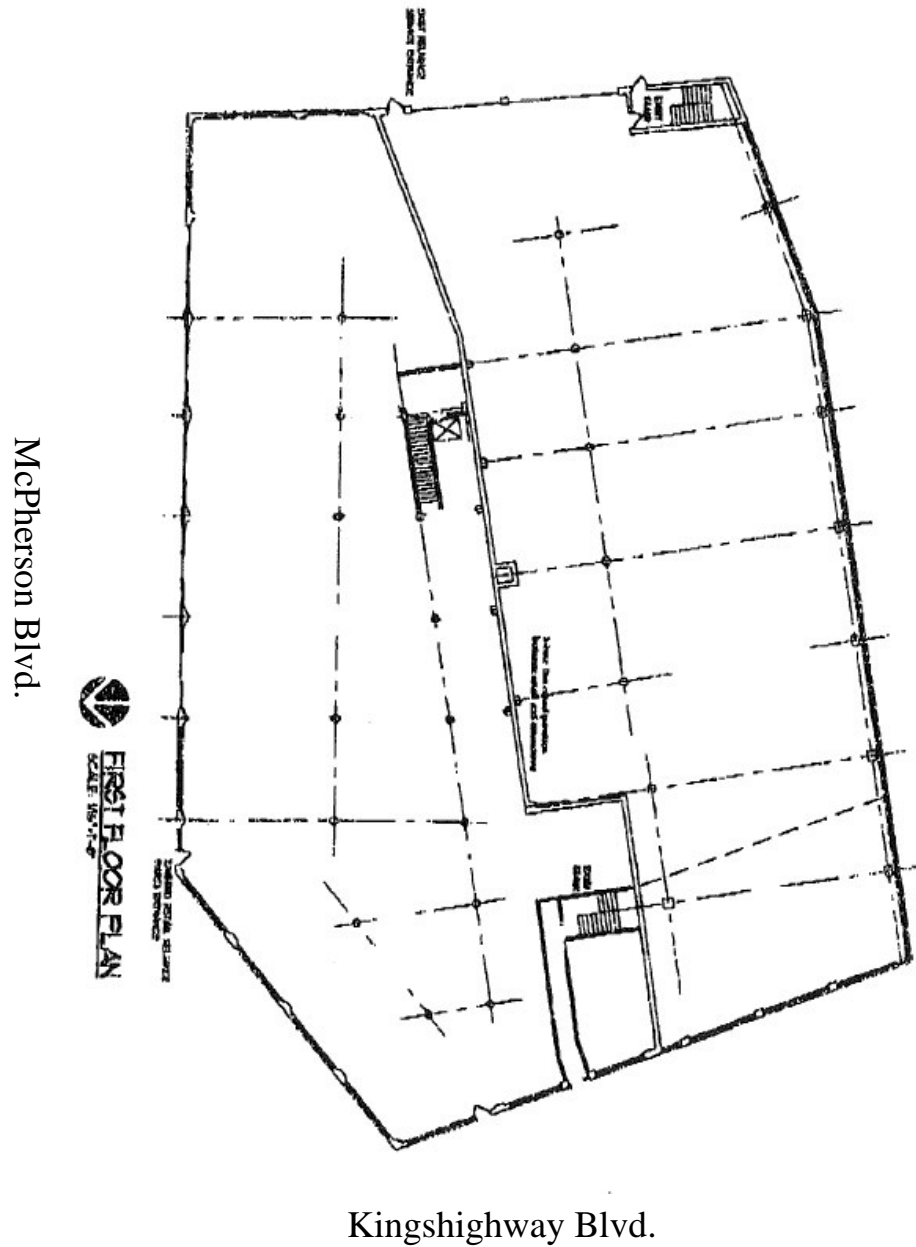

**DUFFE
NUERNBERGER
REALTY**

1425 South 18th Street
St. Louis, Missouri 63104
314-771-5335
314-771-7268 fax

CONTACT:

Susan Sauer
314-571-7654
ssauer@ndconsulting.com

Michele Duffe
314-571-7646

Flyer on the web at: www.dnrealty.com